

Studio Sketch

Objective: handle bass
(40-120) Hz

H = 250
L = 370
W = 320
[cm]

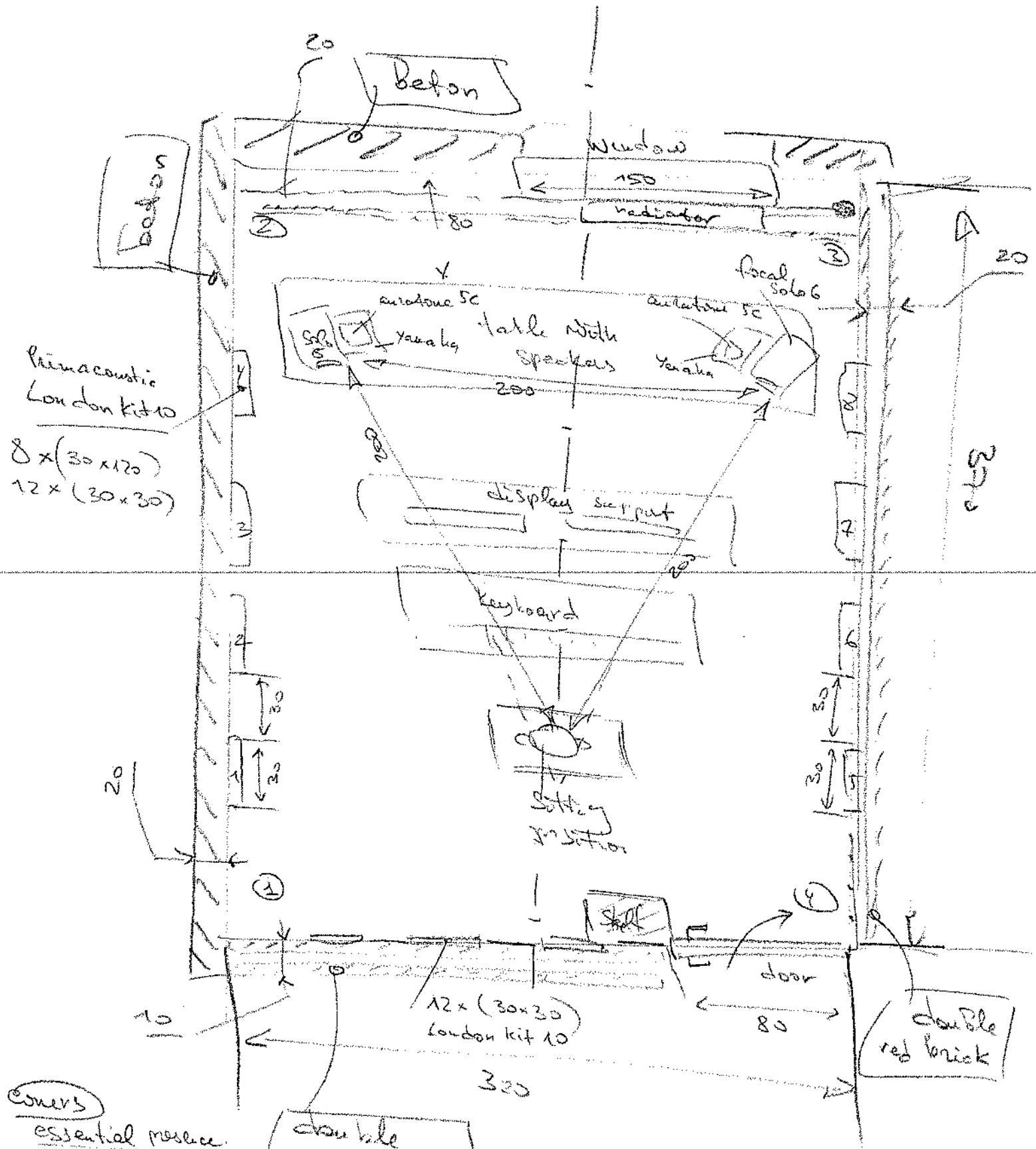

corners

essential presence:

- ① ~ (40-50) Hz Big stat. wave
- ② ~ (80-100) Hz big
- ③ ~ (40-50) Hz huge? (near windows)?
- ④ ~ (80-120) Hz medium